

Type RFT/HS

These high current transformers are based on the current transformer principle, with single or multiple secondary turns. They are suitable for use in test generators for power frequency magnetic fields as specified in EN 61000-4-8:1993. REO also manufacture the variable transformers that are used as voltage regulators.

Features include:

- compact, fully encapsulated, construction
- greatly reduced magnetic stray field
- easy installation (screw fixing)
- enclosed, primary terminals, in accordance with VBG 4
- EMC compliant, no additional devices required
- manufactured in accordance with EN 60742 (VDE 0551)
- higher currents using parallel connection
- optional multiple secondary turns

Custom designs are available



Dimensions

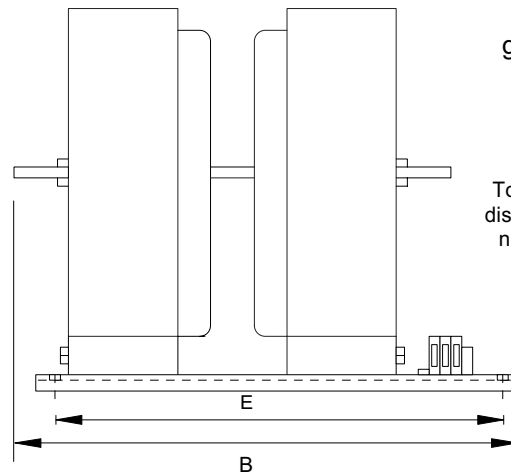
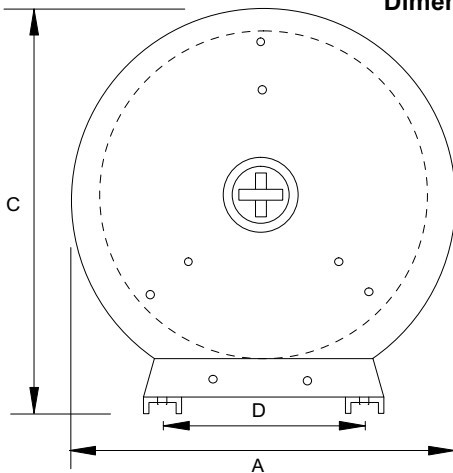

Schematic circuit of the test generator for power frequency magnetic field

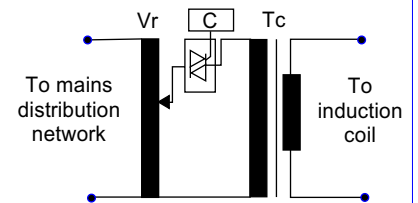

Vr: Voltage Regulator
C: Control Circuit
Tc: Current Transformer

Dimensions	Rated Capacity	Input Voltage	Output Voltage	Output Current	Dimensions (mm)					Weight Kg	Copper kg
					A	B	C	D	E		
RFT/HS-500	815	230	1.67	500	280	300	100	190	260	20	9
RFT/HS-1000	1630			1000						21	9.7
RFT/HS-1500	2445			1500						25	9.9
RFT/HS-2000	1600		0.8	2000			22			10.3	
RFT/HS-3000	2400		3000	26			10.5				
RFT/HS-4000	3200		4000	31			10.6				
RFT/HS-5000	4000		5000	32			11				

Maximum manufacturing range up to 4kVA
Secondary voltages up to 1.67 or 0.8 V

Nominal currents up to 5000 A
Frequency range 50-400 c/s

Temperature class T 40/E

REO (UK) LTD

Units 8-10, Long Lane Industrial Estate
Craven Arms, Shropshire SY7 8DU
Tel: 01588 673411 Fax: 01588 672718
email: sales@reo.co.uk
www.reo.co.uk